



# ASHELTA

## IMPACT

Retractable Roofing System.

Maximum single unit dimensions : 5m by 9m



**Honesty**  
Full price transparency online.



**Design Team**  
Helping you create your dream



**Install network**  
Options nationwide with flexible coverage



**Peace Of Mind**  
Available across all products

# Ashelta : Flat Retractable Roofing System

Roof System: Retractable

Page 1 of 2



The Impact is Corradi's roof only patented covering system composed of a waterproof canvas called Eclissi, which runs on special runners and is supported by aluminium tubes that are anchored onto the supporting frame, commonly made from timber or steel.

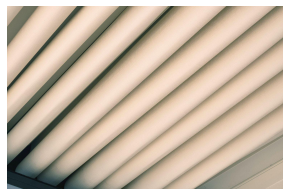

## In Summary

A tubular motor and shaft drives the fabric support belt, these are inside the runners which have supporting brackets made for easy fixing to wood or steel frames. It has curved aluminium fabric support tubes for lateral flow of rainwater which can run into optional integrated gutters.

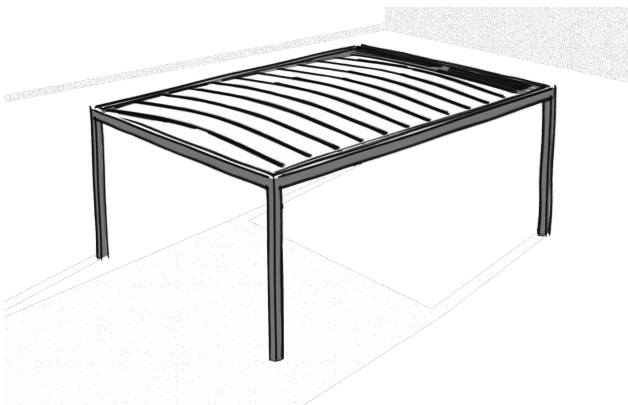

## Average Cost Per Square Metre (inc VAT)

| Projection ↓ | Width → |      |      |      |
|--------------|---------|------|------|------|
|              | < 3m    | < 4m | < 5m | 5m > |
| < 3m         | £450    | £350 | £350 | £300 |
| < 4m         | £400    | £300 | £300 | £150 |
| < 5m         | £350    | £300 | £250 | £150 |
| < 6m         | £350    | £300 | £250 | £100 |
| < 7m         | £350    | £300 | £250 | £100 |
| < 8m         | £350    | £250 | £250 | £100 |
| < 9m         | £300    | £250 | £250 | £100 |
| 9m >         | 300     | 250  | £250 | £100 |

### Example

Width = 4.5m  
Projection = 4.5m

→ 20.25m<sup>2</sup> coverage  
→ ~ £250 per m<sup>2</sup>

Estimate cost of  
£5,062 inc VAT

# Ashelta : Flat Retractable Roofing System

Roof System: Retractable

Page 2 of 2

## Extruded Aluminium **Retractable** Roof Profiles and Dimensions

(All Measurements in mm)

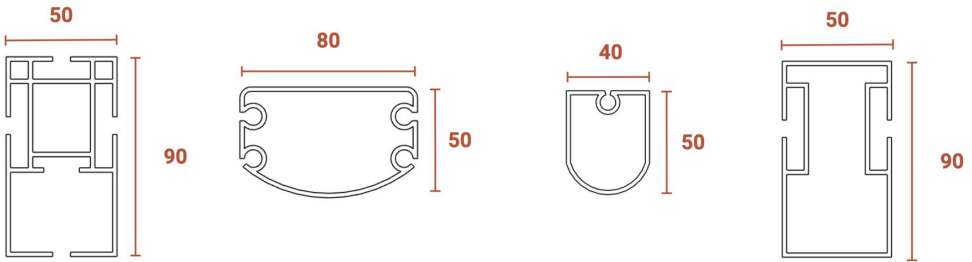

## Width & Projection - Frame and Roof Dimensions

(All Measurements in mm)

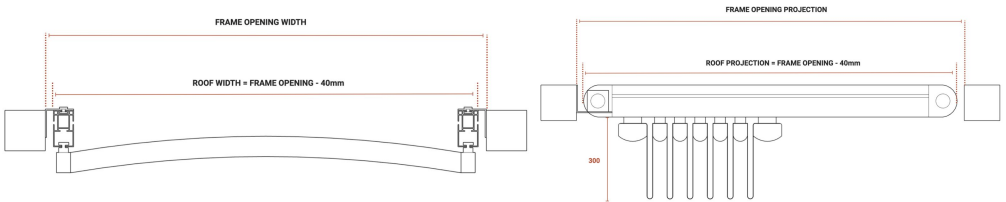

## Frame and Runner **Fixing** Bracket

(All Measurements in mm)

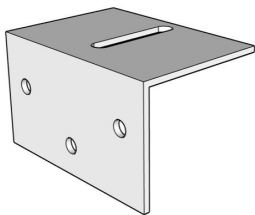

Bracket - Overall

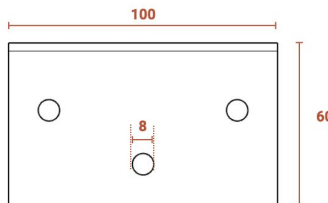

Bracket - Top Profile

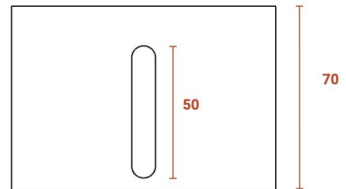

Bracket - Side Profile

## Average Cost Per Square Metre (inc VAT)

|              | Width → |      |      |      |
|--------------|---------|------|------|------|
| Projection ↓ | < 3m    | < 4m | < 5m | 5m > |
| < 3m         | £450    | £350 | £350 | £300 |
| < 4m         | £400    | £300 | £300 | £150 |
| < 5m         | £350    | £300 | £250 | £150 |
| < 6m         | £350    | £300 | £250 | £100 |
| < 7m         | £350    | £300 | £250 | £100 |
| < 8m         | £350    | £250 | £250 | £100 |
| < 9m         | £300    | £250 | £250 | £100 |
| 9m >         | 300     | 250  | £250 | £100 |

### Example

Width = 4.5m  
Projection = 4.5m

→ 20.25m<sup>2</sup> coverage  
→ ~ £250 per m<sup>2</sup>

Estimate cost of  
£5,062 inc VAT